

# Bookcase Overhead

## Install Instructions

### Recommended Tools

- Knife 

### Installation

Note: Due to the product weight, it is recommended two or more people help with the installation of the desk.

1. Identify the product's installation location. Then move and unpack box(es) near the final installation location.
2. Place bookcase onto worksurface (Figure 2).

Figure 1

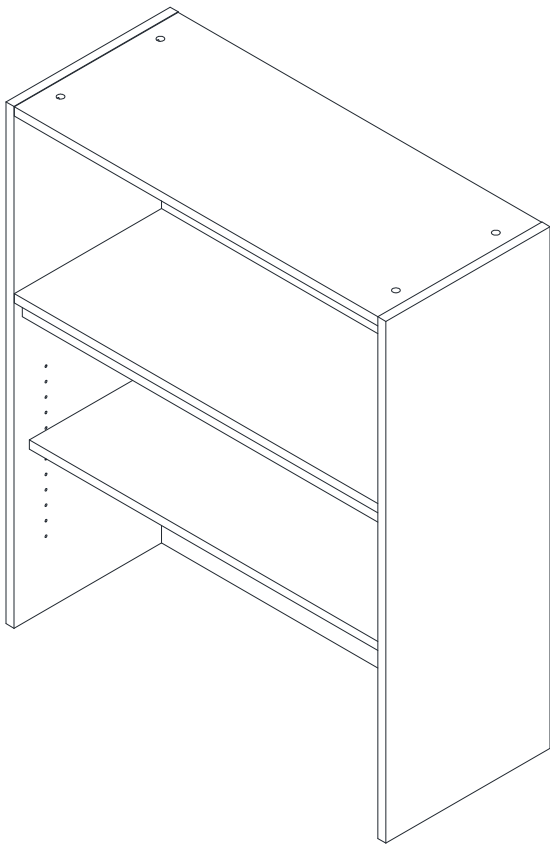

Figure 2

